

MURKIN

Listing of evidence (copies)

44-38861

44-38861-5920



Full Cut #850R - Half Cut #8502R - Third Cut #8503R - Fifth Cut #8505R

7-43 (Rev. 7-12-72)

UNITED STATES GOVERNMENT

Memorandum

Felt _____
Bates _____
Bishop _____
Callahan _____
Campbell _____
Cleveland _____
Conrad _____
Dalbey _____
Jenkins _____
Marshall _____
Miller, E.S. _____
Ponder _____
Soyars _____
Walters _____
Tele. Room _____
Mr. Kinley _____
Mr. Armstrong _____
Ms. Herwig _____
Mrs. Neenan _____

TO : J. W. Marshall

DATE: 6-27-73

FROM : I. W. Conrad

SUBJECT

MURKIN

Marlin

44-38861

There is enclosed the file which has been maintained in the Laboratory in connection with the above-captioned matter. It is desired that this file be maintained as an enclosure to the main file in the Records Branch.

Enc.

"ENCLOSURE ON BULKY RAMP"

44-38861-5920

ENCLOSURE

NOT RECORDED

10 JUN 27 1973

57 JUN 27 1973

LISTING OF MURKIN EVIDENCE
44-38861

| <u>SPECIMEN</u> | <u>DESCRIPTION</u> | <u>CONTRIBUTOR</u> |
|-----------------|---|--------------------|
| Q86 | Reg. card of New Rebel Motor Hotel in name "Eric S. Galt" | Memphis |
| Q87-Q88 | Envelope and aep anonymous letter "Get Tommy Nash" | Miami |
| Q127-Q129 | Typ. env to "Dale L. Dykema" Typ. letter dated 1/21/68 from "Eric S. Galt" Typ. letter from Dykema to Galt re apartment | Los Angeles |
| Q130-Q133 | Typ. let, 10/5/67, re camera from "Eric S. Galt" Typ. let, 10/22/67, re camera from "Eric S. Galt" Typ. let, 11/20/67, re camera from "Eric S. Galt" Order Blank of Sup. Bulk Film Co. in amt. \$337.24 (HP) Also Sub. 6 misc. items of Sup. Bulk Co. | Chicago |
| Q134-Q135 | Enrollment Form of Locksmithing Inst., Little Falls, N. J. in name "Eric S. Galt" Confidentail Info. form of Locksmithing Inst., signed "Eric S. Galt" | Newark |
| Q139-Q140 | Pair of women's black shoes | Los Angeles |
| Q141-Q142 | Provincial Motel reg. card, 12/17/67, signed "Eric S. Galt" 2 sheets of Provincial Motel stationery bearing indented writing impressions | New Orleans |
| Q173 | Change of Address Order, 4/25/68, signed "Eric S. Galt" | Los Angeles |
| Q214 | Torn newspaper clipping bearing hw "Galt 1052 N side Dr. 876 9770" | Atlanta |

Q214

Newspaper
Clipping bearing
notation "GALT, etc."

| SPECIMEN | DESCRIPTION | CONTRIBUTOR |
|----------------------|---|---------------------------------|
| Q215 | Env. pm "Montreal, Can. (HP) to Locksmithing Inst. from Eric S. Galt | Newark |
| Q216-Q224 | Nine BofA Money Orders | Los Angeles |
| Q225-Q226 | Typ. letter "Inclosed is M.O..." signed "Eric S. Galt" Post Office Dept. Appl for Delivery of Mail Through Agent, signed "Eric S. Galt" | Los Angeles |
| Q227-Q228 | Pink env add. "the Federal Bureaw..." Acp. sheet of green paper "Take card of White Mustang...." | Bureau Req. |
| Q246 | Sealed env. to Dr. Tarplee with hp ERIC S. GALT | Atlanta |
| Q247 | Eastern Airlines ticket env, Fl. 399/Y Atl. to Memphis | Atlanta |
| Q248-Q254 | Four payment coupons, order blank, 2 envelopes (re Locksmithing) Envs. contain Lesson No. 8 & No.9 | Newark |
| Q255 | Order blank-Futura Books signed "Eric S. Galt" | Los Angeles |
| Q258-Q262 | Interview card (Dance Analysis) Dance studio enrollment agreement Change of Address form Installment note (bar tending course) App. for School Adm. | Los Angeles |
| Qc263 | Two photocopies "Hotel Rio" reg. card for "Eric S. Galt" | Legat, Mex. City |
| Q265-Q268 | Env. adr to "President of U.S. L. B. Johnson and acp three-page letter | Secret Service, Wash., D. C. |
| Qc288 | Photocopy of Canadian Money Order signed "Eric S. Galt" | |
| Q293-Q294 | Airmail env to Tiffany Enterprises and acp typ. letter enclosing money for handcuffs | Los Angless |

| <u>SPECIMEN</u> | <u>DESCRIPTION</u> | <u>CONTRIBUTOR</u> |
|-------------------------|--|------------------------------|
| Q296-Q297 | Env pm Los Angeles, Apr. '68 Piece of paper with mailing address sticker Mr. Eric S. Galt, 1535 N. Serrano, L.A. 90027 | Los Angeles |
| Qc314 | Photocopy of Cert. of Title in name "Michael St. Pierre" | Jacksonville |
| Q326-Q327 | Modern Photo Bookstore coupon bearing hp of Eric S. Galt Hw let dated 9/26/67 re order for book | |
| Q334 | Typ. letter re emigrating to Rhodesia, signed "Eric S. Galt" | Washington Field |
| Q335-Q336 | | |
| Qc351 | Photocopies of 4-page hw letter dated at Montreal, Que., signed "Code letter 'G' " | Memphis |
| Qc364-Qc366 | Photocopy of form Statutory Declara- tion of Guarantor Appl. for Canadian Passport(photo) Photo of RAY & sig. "Ramon George Sneyd" | Washington Field |
| Qc367 | Photocopy of hp note, 4/20/68, signed Ramon George Sneyd" Also Sub. Photo of partial palm print & passport photo | Buffalo |
| Q386-Q387 | Airmail env from England to Mr. Ramsey Clark and acp. sheet of prison stationery bearing hw let. signed "R. G. Sneyd" | Bureau req. |
| Qc389 | Photos of BB note "PLACE ALL..." and "Tab ALL" (written on brown paper bag) | Legat, London |
| Qc390 | Photocopy of sheet from hotel guest book signed "Ramon George Sneyd" Also Sub. photocopy of hotel statement | Legat, London |
| Qc391 | Photocopy of two-page letter on prison stationery beg. #Dear John" and signed "Lord R. G. Sneyd" | |
| Qc391, Qc396 | Photocopies of envelopes and acp letters to Edward Heath, J. B. Stoner and Arthur Hanes (Also Sub. photocopy of letter to "Dear Jimmy." | |

AS: Records Room Service Laboratory, Los Angeles

Mr. Stephen J. Pollak
Assistant Attorney General

October 25, 1968

Director, FBI

1 - Mr. Long

ASSASSINATION OF MARTIN LUTHER KING, JR.

Mr. Phil M. Canale, Jr., State Attorney General, Shelby County, Memphis, Tennessee, who is handling the State's prosecution of James Earl Ray, has contacted our Memphis Office and requested that all physical evidence pertaining to the James Earl Ray case now in possession of the Bureau be forwarded to his office.

On September 16, 1968, Mr. D. Robert Owen of your Division authorized turning over to Memphis authorities the 1966 Mustang automobile, and Memphis authorities took possession of this car on September 24, 1968. This discussion with Mr. Owen was confirmed by letter dated September 19, 1968.

Mr. Owen on October 24, 1968, advised Special Agent Richard E. Long he had discussed with Mr. Canale the turning over of all evidence to him and as a result thereof, we should comply with the current request of Mr. Canale. We are, therefore, turning over to Mr. Canale all evidence in this case presently in the Bureau's possession. In accordance with Mr. Owen's request, an Agent of our Memphis Office will obtain the remaining evidence from our Laboratory and turn it over to Mr. Canale as this will minimize the testimony required for the chain of evidence.

Attached is a list of the evidence being turned over to Mr. Canale.

Enclosure

REL:mfd
(4)

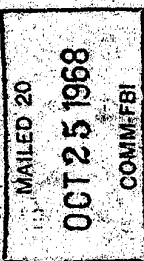

SEE NOTE PAGE 2

Tolson _____
DeLoach _____
Mohr _____
Bishop _____
Casper _____
Callahan _____
Conrad _____
Felt _____
Gale _____
Rosen _____
Sullivan _____
Tavel _____
Trotter _____
Tele. Room _____
Holmes _____
Gandy _____

MAIL ROOM ☐ TELETYPE UNIT ☐

3

Enclosure to
SA

Totalize to
MEMPHIS
10/26/68
RE: Jms

REC'D DE LOACH
OCT 25 10 18 AM '68

Handwritten signature/initials

R

L

NOTE:

Pursuant to instructions of the Department, we retained all of the evidence in this case recovered by us with the exception of the 1966 Mustang in view of the outstanding Federal Civil Rights charge. Department advised that Mr. Canale no doubt needs particular items of evidence in the Bureau's possession and we should furnish any item they request to them.

In view of the current request of Mr. Canale to turn all the evidence over to him, this matter was taken up with the Department on 10/22/68. On 10/24/68, Mr. Owen advised us in line set forth in attached letter. Memphis will be advised accordingly. Our Laboratory has been advised.

Confidential
10-11-66
CERTIFICATE
24 October 1966

We certify that this is a report of psychiatric examination pursuant to the provisions of Section 552.020 RSMo 1963, as ordered by the Circuit Court of Cole County, Cause No. 6305, in the case of JAMES EARL RAY, a 38 year old, single, Caucasian male, who was admitted to Fulton State Hospital on 8 September 1966.

I. PERTINENT HISTORY

Reason for Admission: Pre-trial examination pursuant to Section 552.020 by Circuit Court Order of Cole County alleged to be charged with the crime of attempted escape.

Legal Status: Subject was transferred to this hospital for pre-trial evaluation from the Missouri State Penitentiary, where he was serving a sentence of twenty years, having been convicted of the crimes of first degree robbery and two charges of operating a motor vehicle without the permission of the owner. In addition to the sentence, he is serving, he now has a charge against him of attempted escape.

Pertinent Social History: According to accompanying information received from the Missouri State Penitentiary, at or about 9:00 p.m. on 11 March 1966, the subject attempted to escape and actually had hidden out inside the penitentiary walls until he was discovered at approximately 12:10 a.m. on 13 March 1966 attempting to make his way to the roof from which he apparently planned to scale the prison wall. He had placed a dummy in his bed to cover up for his absence at the 9:00 a.m. count on 11 March and had taken a 14 foot iron rod with a metal hook on the end with which he was able to scale several feet of one of the walls inside the penitentiary. He had cut a hole through a security screen on a window and had been hiding out from search parties on various areas of the roof.

Mr. James Ray was born on [redacted] in Illinois. The record indicates that he completed ten grades of school and entered the Army in February 1946, where he served until December 1948, at which time he was discharged because of a lack of adaptability. His FBI record comprises one and one half pages and shows numerous arrests for a variety of charges. He has served sentences in various penal institutions on conviction of such charges as robbery, forgery of postal money orders, and car theft. He has been incarcerated in one or another penal institution a good part of his adult life.

II. PHYSICAL STATUS

There is no physical disease or defect which requires treatment at this time.

Laboratory Data: 9 Sep 66: Urinalysis essentially negative. Hematology within normal limits. Serum bromides negative. Blood sugar and blood urea nitrogen were within normal limits. VDRL nonreactive. 13 Sep 66: Chest x-ray reported as negative.

II. MENTAL STATUS

Orientation: He is oriented for time, place and person.

Memory: His memory is unimpaired for both recent and remote events.

Speech and Mental Activity: He is coherent, alert, relevant and there are no hallucinations or delusions.

Mood and Affect: He appeared to be somewhat tense and anxious and at times showed some mild depression but not of psychotic proportions.

Insight and Judgment: He has a good verbal assessment of reality but in the past he has used poor judgment.

Psychological Testing: Psychological tests indicate that he has an IQ of 105 which places him within the average range of intellectual functioning. Tests also showed some degree of depression. The psychological tests showed no evidence of a psychosis.

IV. COURSE IN HOSPITAL

He has made a good hospital adjustment and has not been a management problem.

V. CONDITION AT PRESENT

Unchanged.

VI. DIAGNOSIS

Sociopathic Personality, Antisocial Type with anxiety and depressive features.

VII. DISCUSSION

Patient has been observed, studied and tested. No symptoms or signs indicating a mental disease or defect could be found. Although he showed signs of anxiety and depression, these could not be considered of psychotic proportions.

VIII. FINDINGS

- 1) That the accused has no mental disease or defect within the meaning of Section 552.010.
- 2) That the accused has the capacity to understand the proceedings against him and can assist in his own defense.
- 3) That the accused did know and appreciate the nature, quality and wrongfulness of his conduct.

IX. RECOMMENDATION

It is recommended that he be returned to the Missouri State Penitentiary.

Jack C. Cotton, D.O.

Assistant Director of Prison

E. C. Kessler, M.D.

Director of State Building

Assassination of Martin Luther King, Jr.

Evidence recovered by FBI

Original invoice and copy from Aeromarine Supply Company,
dated 3/29/68, from FBI Birmingham

ITEMS FROM 1966 FORD MUSTANG: (from FBI, Atlanta)

Floor mat from right front floor
Floor mat from rear floor
Floor mat from left front floor
Floor mat from trunk
Air filter cartridge
Wheel jack from trunk
Dark blue short sleeve sweat shirt
One rubber shoe, size 7-8 $\frac{1}{2}$
One white fitted sheet
One black and white shirt jacket
One pillowcase
One fitted sheet with yellow thread
One black sport shirt
One pair of size 34 walking shorts
Rug from trunk
Pillow from trunk
Styrofoam container from trunk
One pair of men's brown socks from trunk
One hunting knife and sheath
Spare tire mounting from trunk
Lug wrench from trunk
Blue-handled screwdriver from trunk
Used windshield wiper blade from trunk
One Personna razor blade
Soil sample from spare wheel and tire
Vacuum sweepings from front passenger side floor
Vacuum sweepings from left front floor
Vacuum sweepings from rear floor
Vacuum sweepings from trunk

ITEMS FROM 1966 FORD MUSTANG: (from FBI, Atlanta)

A piece of Kleenex box bearing letters "At pool" on one
side and names "Ginger Day and Anita Katzwinkel,
1535 Serrano, Apt. 6," on other side
One air release shutter in original package
Sunglasses with case
Two pieces of cardboard from trunk
Scraps of paper from glove compartment
Scraps of paper from under rear seat

(from FBI, Atlanta)

- Soil from right fender well
- Soil from right fender well
- Soil from right rear wheel
- Soil from right rear fender well
- Debris from lower part of left fender
- Soil from left front wheel
- Soil from left rear wheel
- Scraping from front left tire tread
- Soil from underneath body in front of differential
- Soil from differential
- Soil from front of exhaust pipe
- Soil from underneath body in front section
- Soil from left fender well
- Soil from left rear fender well
- Scrapings from left rear tire tread
- Scrapings from tread of right rear tire
- Scrapings from under glove compartment
- Scrapings from tire tread, right front tire
- Scrapings from front part of engine
- Water from windshield washer bag
- Spare tire and wheel from trunk

ITEMS FROM ROOM 6, 113, 14th ST., NE, ATLANTA, GEORGIA:
(from FBI, Atlanta)

- Bed sheet
- Bed sheet
- Standard Oil map of Atlanta
- Partial book of matches bearing advertisement of "Albert Pick"
- Piece of lined paper
- Newspaper from shelf
- Piece of pink paper bearing hand printed name "Jimmy Ower"
- Keyhole saw

ITEM FROM ROOM 5, 107, 14th St., NE, ATLANTA, GEORGIA:
(from FBI, Atlanta)

Section of newspaper dated 4/7/38

(received from FBI, Atlanta)

- Booklet entitled "What is the John Birch Society"
- Gulf Oil Company map of Atlanta
- "Arrow" map of greater Atlanta
- Box of Nabisco saltine crackers

(received from FBI, Atlanta)

- Jar of French's mustard
- Coffee cup
- Water glass
- Small can of Carnation evaporated milk
- Jar of Maxwell House instant coffee
- Box of "C & H" sugar
- One knife (Forgecraft)
- One National's Citation pencil
- Wire electric cup heater
- One portable Zenith television, Model #N 2205-6
- Jar of Kraft's Catalina French Dressing
- Package of Golden Grain California lima beans
- Can of "Iris" ground black pepper
- Box of five National's Citation pencils
- Gulf map of Southeastern USA
- Shell map of Texas and Oklahoma
- Map of Mexico
- Map of Los Angeles published by Mitock & Sons
- Map of Los Angeles (Richfield)
- Shell map of Louisiana
- Map of California
- Enco map of Arizona and New Mexico
- Standard Oil map of Birmingham and vicinity
- Tie (brown with brown, blue and silver diagonal stripes)
- Pair of grey trousers
- Booklet entitled "Your Opportunities in Locksmithing"

(received from FBI, Atlanta)

- Four coat hangers
- Two cardboard inserts for coat hangers
- Handkerchief
- Pair of socks

ITEMS FROM ROOM 2, 113 14TH STREET, NORTHEAST, ATLANTA, GEORGIA:

(received from FBI, Atlanta)

- Large key blank
- Small key blank
- Piece of black thread
- Piece of brown thread with needle
- Metal strip, $\frac{1}{2}$ " by $1\frac{1}{2}$ "
- Business card for "HANEY'S SHEET METAL"
- White shirt received from FBI, Newark

Material from ashtray received from FBI, New Orleans

Six sets of type used in Thermo Seal machines,
further described as follows: (from FBI, Albany)

| <u>Type size</u> | <u>Characters</u> |
|-----------------------|-------------------|
| Regular 18-point type | Letters |
| Regular 18-point type | Numbers |
| Narrow 18-point type | Letters |
| Regular 15-point type | Numbers |
| Narrow 15-point type | Letters |
| Narrow 15-point type | Numbers |

Strip of $\frac{1}{4}$ " red Thermo Seal marking tape received from
FBI, Albany

Can of Schlitz beer, 12-ounce size from Southaven
Minnow Shop, received from FBI, Jackson

Brown paper bag from Southaven Minnow Shop, received from
FBI, Jackson

Also Submitted: (received from FBI, Atlanta).

Four lifts of latent impressions found on automobile
Rearview mirror from 1966 Ford Mustang
1967 Alabama license plate 1A-88354
1968 Alabama license plate 1-38993
Three cigarette butts from top of wardrobe, Room 6
One cigarette butt from under wardrobe, Room 6
Ten latent lifts from Room 6
Latent lifts A1 through A3 from Room 5

ITEMS RECEIVED FROM FBI, MEMPHIS

25 lifts from room #34 of Rebel Motor Hotel
Elimination fingerprints of N. E. Zachary and
Jewel Greer Roy
Elimination fingerprints of 21 individuals
(1 latent from "flop house" eliminated
1 latent from Rebel Motel registration
card eliminated)

ITEMS RECEIVED FROM FBI, BIRMINGHAM

Remington rifle box
Box of cartridges
Safe deposit box #5517 from Birmingham Trust
National Bank
Fingerprints of six bank employees
Palm prints and finger-tip impressions of five
Birmingham Trust National Bank employees
Bank draft for \$337.24, payable to Superior
Bulk Film Company
Major case prints of two Aeromarine Supply Co.
clerks

ITEMS RECEIVED FROM FBI, ATLANTA

Five transparent lifts from 66 Mustang
Luncheon check from "Mammy's Shanty Restaurant"

ITEMS RECEIVED FROM FBI, NEW ORLEANS

Nine items recovered from room at 623 Royal
Street in New Orleans

ITEMS RECEIVED FROM FBI, MIAMI

Piece of brown wrapping paper with label
bearing #777, etc.
Piece of brown wrapping paper with label
bearing #6829
Cardboard box

ITEMS RECEIVED FROM FBI, BUFFALO

Photo of Liberty National Bank Dealer
Plan form -
Known handwriting of DR. ALVIN FRENCH

ITEMS RECEIVED FROM FBI, LOS ANGELES

Known handwriting of KATZWINKEL
Known handwriting of FLIKEID
Chevron map of Los Angeles
Chevron map of California

ITEMS RECEIVED FROM FBI, JACKSONVILLE

Known handwriting of DR. ALVIN FRENCH
(postcard)

ITEMS RECEIVED FROM FBI, CHICAGO

Known handwriting of GINGER NANCE
Known handwriting of THOMAS FLIKEID and
SUSAN FLIKEID
Known handwriting of JERRY WM. RAY

ITEMS RECEIVED FROM FBI, BIRMINGHAM

BORSARI checks

ITEMS RECEIVED FROM FBI, ATLANTA

Known handwriting of JOHN WILLARD

ITEMS RECEIVED FROM FBI, MOBILE

Known handwriting of 11 persons (obtained
from Ala. State Dept. of Safety,
Montgomery, Alabama)

MISCELLANEOUS LAUNDRY TAPES RECEIVED FROM NUMEROUS FBI OFFICES

ITEMS BEING PERSONALLY DELIVERED TO MR. CANALE BY LABORATORY
EXAMINER MORTIMER

(From FBI, Memphis)

Registration card of New Rebel
Motel in name "Eric S. Galt"
Photocopy of four-page handwritten
letter dated at Montreal, Que.,
signed "Code letter 'G'"
Bar of Cameo toilet soap

(From FBI, Miami)

Envelope and accompanying letter
"Get Tommy Nash"

(From FBI, Los Angeles)

Typewritten letter dated 1/21/68 with
envelope from "Eric S. Galt"
Typewritten letter from Dykema to Galt
re apartment
Pair of women's black shoes
Change of Address order dated 4/25/68
signed "Eric S. Galt"
Nine Bank of America money orders
Typewritten letter "Inclosed is MO.."
signed Eric S. Galt"
Post Office Department Application
for Delivery of Mail Through Agent,
signed "Eric S. Galt"
Order blank of Futura Books, signed
"Eric S. Galt"
Interview Card
Dance studio enrollment agreement
Change of Address form
Installment note (bar tending course)
Application for School Admittance
Airmail envelope to Tiffany Enterprises
and accompanying typewritten letter
enclosing money order for handcuffs
Envelope postmarked Los Angeles,
Apr. '68, mailing address sticker
"Mr. Eric S. Galt, 1535 N. Serrano,
L. A. 90627"

(From FBI, Chicago)

Typewritten letter dated 10/5/67 re
camera from "Eric S. Galt"
Typewritten letter dated 10/22/67 re
camera from "Eric S. Galt"
Typewritten letter dated 11/20/67 re
camera from "Eric S. Galt"
Order blank from Sup. Bulk Film Co.
in amount of \$337.24 (hand printed)
Also Submitted: 6 miscellaneous items
of Sup. Bulk Co.

(From FBI, Newark)

Enrollment form of Locksmithing Inst.,
Little Falls, N. J., in name "Eric S.
Galt"
Confidential Information form of
Locksmithing Inst., signed "Eric S. Galt"
Envelope postmarked Montreal, Canada,
(hand printed) to Locksmithing Inst.
from "Eric S. Galt"
Four payment coupons, order blank,
two envelopes re Locksmithing,
Envelopes containing lessons #8 and #9
Photocopy of Canadian Money Order
signed "Eric S. Galt"

(From FBI, New Orleans)

Provincial Motel registration card
dated 12/17/67, signed "Eric S. Galt"
Two sheets of motel stationery bearing
indented writing impressions

(From FBI, Atlanta)

Newspaper clipping bearing handwriting
"Galt 1052 N side Dr. 8769770"
Sealed envelope to Dr. Tarplee with
hand printing of Eric S. Galt
Eastern Airlines ticket envelope,
F1.390/Y, Atlanta to Memphis

(From FBI, Headquarters)

Pink envelope addressed "The Federal
Bureau..."

(From FBI, Jacksonville) (re Jacksonville)

Photocopy of Certificate of Title in
the name "Michael St. Pierre"

(From FBI, New York)

Modern Photo Bookstore coupon bearing
hand printing of "Eric S. Galt" and
handwritten letter dated 9/26/67

(From FBI, Washington Field)

Typewritten letter re emigrating to
Rhodesia signed "Eric S. Galt"
Photocopy of Statutory Declaration of
Guarantor form
Application for Canadian Passport (photo-
graph)
Photograph of RAY and signature
"Ramon George Sneyd"

(From FBI, Buffalo)

Photocopy of hand printed note dated
4/20/68, signed "Ramon George Sneyd"
Also Submitted: Photograph of partial
palm print and passport photograph

(From FBI, Mobile)

Photocopies of Alabama
1968 Motor Vehicle forms

(From FBI, Birmingham)

Known handwriting of ERIC S. GALT
(safe deposit records, ledger card
and letter)

(From FBI, Kansas City)

Known handwriting of JAMES EARL RAY (Missouri
State Pen form)
Known handwriting and hand printing
of JAMES EARL RAY (documents from
Missouri State Pen)
Known handwriting and hand printing of
JAMES EARL RAY (21 sheets of paper
and one form)
Also Submitted: Inmate Request form
for JACK M. RAY



FEDERAL BUREAU OF INVESTIGATION
WASHINGTON, D. C. 20535

1 - Mr. Rosen
 1 - Mr. Trotter
 Att: Mr. Bonebrake
 1 - Mr. Long
 1 - Mr. Conrad
 1 - Mr. Griffith
 Att: Mr. Mortimer
 1 - Mr. Clark
 1 - Mr. Frazier
 1 - Lab Files
 1 - Office, 7133

To: **FBI, Memphis (44-1987)**

Date: **April 19, 1968**

Q-99-

Re: **MURKIN**

J. Edgar Hoover
 John Edgar Hoover, Director

Examination requested by: **Memphis and Atlanta**

Reference: **Letters 4/11/68 and 4/12/68;**
Airtels 4/11/68, 4/12/68 and 4/13/68

Examination requested: **Microscopic - Chemical Analyses -**
Miscellaneous - Document -
 Remarks: **Fingerprint**

FBI File No. **44-38861**
 Lab. No. **PC-A5627 IZ KS**
D-560623 JK
PC-A5655 KS IS KZ
PC-A5656 KS
PC-A5693 KS
PC-A5695 KS

This report confirms and supplements Butels to Memphis and Atlanta, 4/12/68 and 4/13/68.

You are being advised separately concerning the fingerprint examinations.

All of the submitted evidence is being temporarily retained in the Laboratory.

Enclosures (2) (2 Lab report)
2 - Atlanta (44-2386) Enclosures (2) (2 Lab report)

MSC:gan (14)

ADMINISTRATIVE PAGE

Q285 Material from ashtray received from FBI, New Orleans

K33 Six sets of type used in Thermo Seal machines,
further described as follows: (from FBI, Albany)

| <u>Type size</u> | <u>Characters</u> |
|-----------------------|-------------------|
| Regular 18-point type | Letters |
| Regular 18-point type | Numbers |
| Narrow 18-point type | Letters |
| Regular 15-point type | Numbers |
| Narrow 15-point type | Letters |
| Narrow 15-point type | Numbers |

K34 Strip of $\frac{1}{4}$ " red Thermo Seal marking tape received from
FBI, Albany

K169 Can of Schlitz beer, 12-ounce size from Southaven
Minnow Shop, received from FBI, Jackson

K170 Brown paper bag from Southaven Minnow Shop, received from
FBI, Jackson

Also Submitted: (received from FBI, Atlanta)

Four lifts of latent impressions found on automobile
Rearview mirror from 1966 Ford Mustang
1967 Alabama license plate 1A-88354
1968 Alabama license plate 1-38993
Three cigarette butts from top of wardrobe, Room 6
One cigarette butt from under wardrobe, Room 6
Ten latent lifts from Room 6
Latent lifts 1 through 3 from Room 5

(received from FBI, Atlanta)

- Q178 Jar of French's mustard
- Q179 Coffee cup
- Q180 Water glass
- Q181 Small can of Carnation evaporated milk
- Q182 Jar of Maxwell House instant coffee
- Q183 Box of "C & H" sugar
- Q184 One knife (Forgecraft)
- Q185 One National's Citation pencil
- Q186 Wire electric cup heater
- Q187 One portable Zenith television, Model #N 2205-6
- Q188 Jar of Kraft's Catalina French Dressing
- Q189 Package of Golden Grain California lima beans
- Q190 Can of "Iris" ground black pepper
- Q191 Box of five National's Citation pencils
- Q192 Gulf map of Southeastern USA
- Q193 Shell map of Texas and Oklahoma
- Q194 Map of Mexico
- Q195 Map of Los Angeles published by Mitock & Sons
- Q196 Map of Los Angeles (Richfield)
- Q197 Shell map of Louisiana
- Q198 Map of California
- Q199 Enco map of Arizona and New Mexico
- Q200 Standard Oil map of Birmingham and vicinity
- Q201 Tie (brown with brown, blue and silver diagonal stripes)
- Q202 Pair of grey trousers
- Q203 Booklet entitled "Your Opportunities in Locksmithing"

(received from FBI, Atlanta)

- Q229-Q232 Four coat hangers
- Q233-Q234 Two cardboard inserts for coat hangers
- Q235 Handkerchief
- Q236-Q237 Pair of socks

ITEMS FROM ROOM 2, 113 14TH STREET, NORTHEAST, ATLANTA, GEORGIA:

(received from FBI, Atlanta)

- Q240 Large key blank
- Q241 Small key blank
- Q242 Piece of black thread
- Q243 Piece of brown thread with needle
- Q244 Metal strip, $\frac{1}{2}$ " by $1\frac{1}{2}$ "
- Q245 Business card for "HANEY'S SHEET METAL"
- Q264 White shirt received from FBI, Newark

(from FBI, Atlanta)

- Q143 Soil from right fender well
- Q144 Soil from right fender well
- Q145 Soil from right rear wheel
- Q146 Soil from right rear fender well
- Q147 Debris from lower part of left fender
- Q148 Soil from left front wheel
- Q149 Soil from left rear wheel
- Q150 Scraping from front left tire tread
- Q151 Soil from underneath body in front of differential
- Q152 Soil from differential
- Q153 Soil from front of exhaust pipe
- Q154 Soil from underneath body in front section
- Q155 Soil from left fender well
- Q156 Soil from left rear fender well
- Q157 Scrapings from left rear tire tread
- Q158 Scrapings from tread of right rear tire
- Q159 Scrapings from under glove compartment
- Q160 Scrapings from tire tread, right front tire
- Q161 Scrapings from front part of engine
- Q162 Water from windshield washer bag
- Q163 Spare tire and wheel from trunk

ITEMS FROM ROOM 6, 113, 14th ST., NE, ATLANTA, GEORGIA:

(from FBI, Atlanta)

- Q164 Bed sheet
- Q165 Bed sheet
- Q166 Standard Oil map of Atlanta
- Q167 Partial book of matches bearing advertisement of "Albert Pick"
- Q168 Piece of lined paper
- Q169 Newspaper from shelf
- Q170 Piece of pink paper bearing hand printed name "Jimmy Owen"
- Q171 Keyhole saw

ITEM FROM ROOM 5, 107, 14th St., NE, ATLANTA, GEORGIA:

(from FBI, Atlanta)

- Q172 Section of newspaper dated 4/7/68

(received from FBI, Atlanta)

- Q174 Booklet entitled "What is the John Birch Society"
- Q175 Gulf Oil Company map of Atlanta
- Q176 "Arrow" map of greater Atlanta
- Q177 Box of Nabisco saltine crackers

Evidence from MURKIN Case

Q74-Q75 Original invoice and copy from Aeromarine Supply Company,
dated 3/29/68, from FBI Birmingham

ITEMS FROM 1966 FORD MUSTANG: (from FBI, Atlanta)

- Q89 Floor mat from right front floor
- Q90 Floor mat from rear floor
- Q91 Floor mat from left front floor
- Q92 Floor mat from trunk
- Q93 Air filter cartridge
- Q94 Wheel jack from trunk
- Q95 Dark blue short sleeve sweat shirt
- Q96 One rubber shoe, size 7-8 $\frac{1}{2}$
- Q97 One white fitted sheet
- Q98 One black and white shirt jacket
- Q99 One pillowcase
- Q100 One fitted sheet with yellow thread
- Q101 One black sport shirt
- Q102 One pair of size 34 walking shorts
- Q103 Rug from trunk
- Q104 Pillow from trunk
- Q105 Styrofoam container from trunk
- Q106 One pair of men's brown socks from trunk
- Q107 One hunting knife and sheath
- Q108 Spare tire mounting from trunk
- Q109 Lug wrench from trunk
- Q110 Blue-handled screwdriver from trunk
- Q111 Used windshield wiper blade from trunk
- Q112 One Personna razor blade
- Q113 Soil sample from spare wheel and tire
- Q114 Vacuum sweepings from front passenger side floor
- Q115 Vacuum sweepings from left front floor
- Q116 Vacuum sweepings from rear floor
- Q117 Vacuum sweepings from trunk

ITEMS FROM 1966 FORD MUSTANG: (from FBI, Atlanta)

- Q118 A piece of Kleenex box bearing letters "At pool" on one side and names "Ginger Day and Anita Katzwinkel, 1535 Serrano, Apt. 6," on other side
- Q119 One air release shutter in original package
- Q120 Sunglasses with case
- Q121 Two pieces of cardboard from trunk
- Q122 Scraps of paper from glove compartment
- Q123 Scraps of paper from under rear seat

MURKIN EVIDENCE (KNOWN SPECIMENS)

| <u>SPECIMEN</u> | <u>DESCRIPTION</u> | <u>CONTRIBUTOR</u> |
|-----------------|--|--------------------|
| Kc4 | Photocopies of Alabama 1968 Motor Vehicle forms | Mobile |
| K5 | Known handwriting of ERIC S. GALT (safe deposit records, ledger card and letter) | Birmingham |
| K171 | Known handwriting of JAMES EARL RAY (Missouri State Pen form) | Kansas City |
| K211 | Known handwriting and hand printing of JAMES EARL RAY (documents from Missouri State Pen) | Kansas City |
| K257 | Known handwriting and hand printing of JAMES EARL RAY (21 sheets of paper and one form) Also Sub. -Inmate Request form for JACK M. RAY | Kansas City |

Q:112 Personna double edge
razor blade.
no hairs

Q111 Windshield wiper blade (alk rubber)
& 2 slender metal strips (mounting strips)
for blade

ANCO brand "10" molded in
rubber. Part of rubber is missing from.

Q110 Screw driver - flat blade

Blue wooden handle

" STANLEY 141270 " } imprinted on
HANDYMAN " } handle in white

Blade - $2\frac{7}{8}$ " long . tip $\frac{3}{16}$ " wide

"MADE IN U.S.A." stamped in ferrule.

Q109 ratchet lug wrench. type
issued in Mustangs
no debris

Q108

5 spare tire mounting from trunk

4 pcs - washer, bolt (hook on 1 end), wing nut,
wire clip.

No debris

Type furnished 2 Mustangs

Q107 Hunting knife and sheath

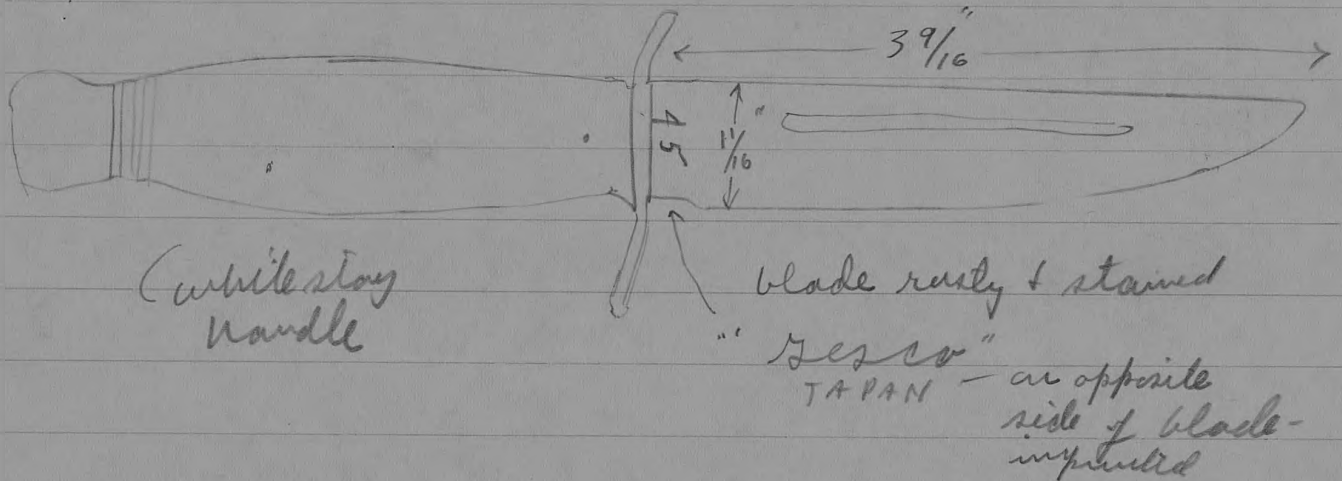

gesco stamped on sheath (brown leather)

Q106 Pair of men's brown stretch
socks. syn. used.
No marks.

Q105

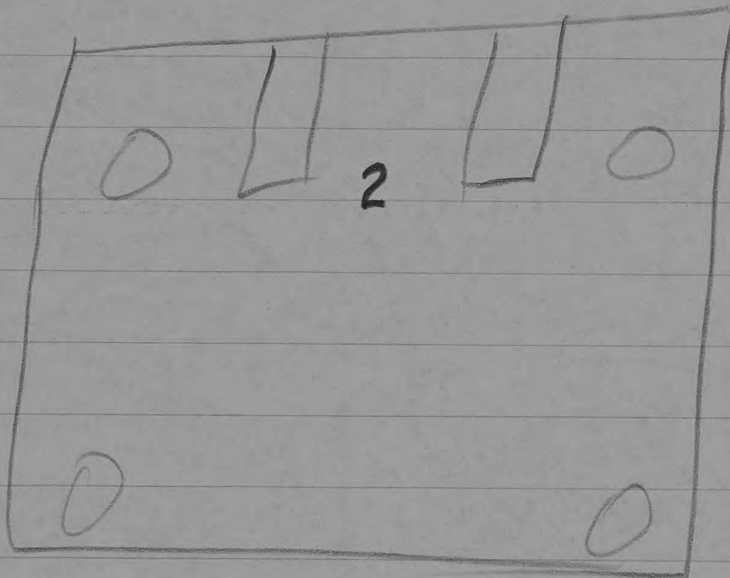
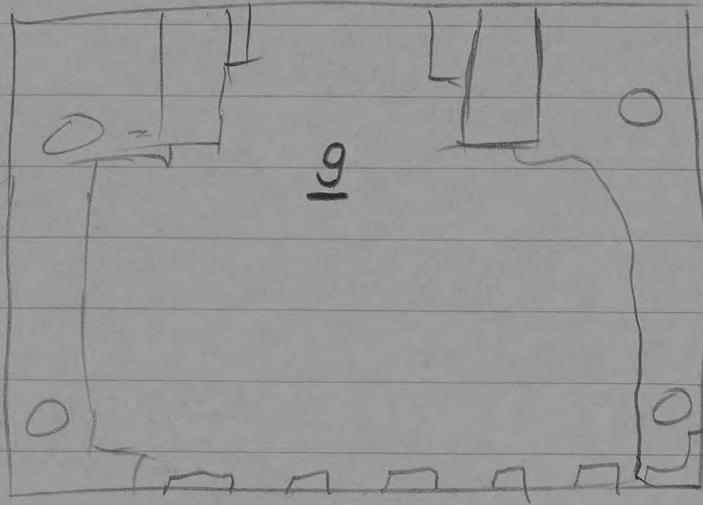

Q105 white styrofoam case or box
Molded to fit a specific item
case is in 2 pcs

overall outside measurements

7" x 8 7/8" x 4 1/6"

No labels or markings other than
one pc has no "2" molded (raised) }
other pc has "9" " (raised)

Located box for Polaroid camera
model 230 at Tannen's. Like Q105
except one pc has no "3" & other pc
has "6."

Q104 Pillow

Blue & green floral design on white background.
ca 19" x 24"

cloth label sewn to one end:

| | |
|---|---|
| ALL NEW MATERIAL CONSISTING OF CRUSHED LANDFOWL FEATHERS | |
| REG. NO. CAL. 2823 | CERTIFICAT- ION IS MADE THAT THE MATERIALS IN THIS ARTICLE ARE DESCRIBED IN ACCORD- ANCE WITH LAW. |
| MADE EXPRESSLY FOR | |
| FM. SIZE 20x26 | |
| F.T.C. REQUIREMENT-RN21666 COVERING ALL COTTON | |

9 1967

Stamped on back
of tag.

Q103 Rug from trunk
light pink - loop pile cotton
Dirty, stained
no marks
24" x 56 1/2"

Q102 Pair of walking shorts. Mens
appear new. olive green

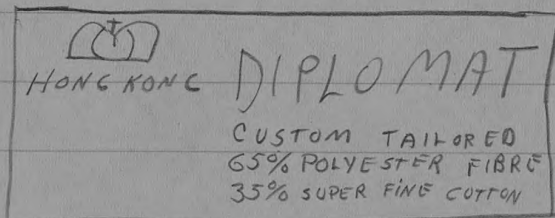

inseam 7 1/4"

WAIST
34 - verified by measurement

No invisible landmarks

Q101 Black short sleeved sport shirt

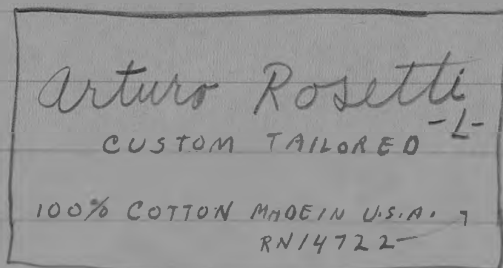

no buttons missing

no lower than #2 grade ^{irregular} sheets

Beale advised that the stitch of the yellow thread is called a whip stitch. He also stated that the whip stitched seam is "the worst job I have ever seen". He said on irregular sheets the only label is a paper label and this label never has the textile mill's name on it.

He further stated that muslin sheets are rare in the U.S. due to the competition of Hong Kong muslin imports.

MURKIN

11/1/68

Wallace

Q100

Mrs. Marrie McAvey, Abbott's Plaff Sewing Center, 800 F St. N.W., Washington, D.C. advised that the stitching with the yellow thread on the Q100 sheet was done at a textile factory or on a commercial sewing as no home sewing machine is capable of making the stitch.

Ronald Beale, carpet buyer for Lansburgh's Department Store, E St. N.W., Washington, D.C. advised he was the buyer for Lansburgh's bargain basement and ^{used to} purchase linen while he was in this position.

He stated the Q100 sheet is a #3 grade ^{irregular} seamed sheet and ^{90%} ~~most~~ of the #3 grade sheets manufactured in the U.S. are sold out of the country. The remaining 10% of the #3 grade sheets which are sold in the U.S. are sold in the low class "illegitimate stores". Beale stated that "most legitimate stores sell

2100 white fitted bed sheet

Twin bed size. soiled. 52" x 71 1/2"

sheet is in 2 pcs

Sheet has been cut all way across width at ca 22" from one end (meas from where top end edge of mattress would be) pcs are then machine stitched together. 2 yellow threads + 2 white threads were stitched at same time

stitching 6 per" in.

1/2" stitches



cut ends of sheet pcs do not appear to match.

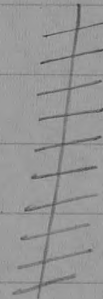

No labels. No vis or invis

Q99 Pillowcase white cotton

19" x 30"
^{cloth}

Laundry tape on hem: $\frac{1}{4}$ " x $1\frac{1}{16}$ "

20R - 3

Black characters
on white background

Q 98 Black + white shirt jacket

Labels:

1. M RN 19788 65% DACRON 35% COTTON
15-15 1/2

2. MONTICELLO®

3. Shirt Jacket Tapered

No buttons missing

No visible laundry marks

Q 97 white fitted bed sheet
Twin bed size 50" x 70"
Soiled
Laundry tape: $\frac{1}{4}$ " x $1\frac{3}{32}$ "

POR-3 : black characters
on white background

Q96 Blk & white rubber sandal
Label on sole

Left foot

| |
|-----------|
| MEN'S - M |
| SHOE SIZE |
| 7-8 1/2 |
| JAPAN |

Q 95

Dark blue short sleeved sweatshirt
Medium, No labels.
No laund tags

Q 94

Jack from trunk

issors jack (RH) - stamped in metal on top
debris in plx removed from screw

SEE OWNERS MANUAL
FOR JACKING INSTRUCTIONS

white gummed paper label
on side

Tjffe furnished 2 Mustangs

Q93 Air filter Cartridge
"PUROLATOR AFP-45" in
raised characters on Q93

Q92 Floor mat from trunk

Rubber

Blk & gray (2 shades) plaid design

No marks

Stained

Q91

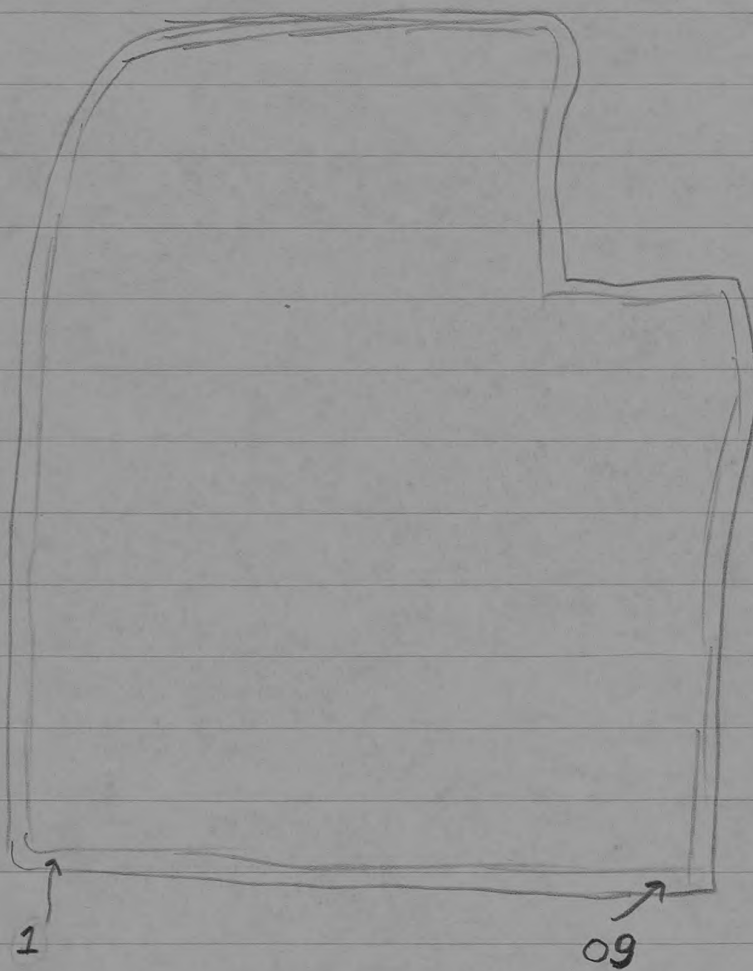

Q91 Floor mat from left front

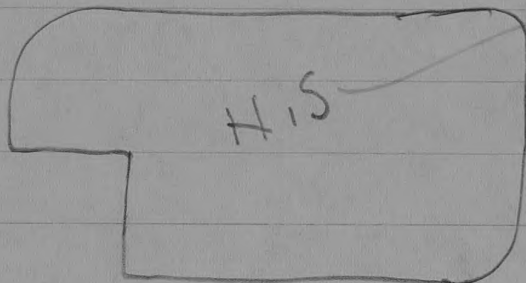

handpainted in
blk - appears to be
felt tip marker

letters on reverse side

red translucent plastic