

~~SECRET~~/NOFORN - HANDLE VIA SKEET CHANNELS ONLY

25 Oct

PROJECT SUN STREAK (U)

WARNING NOTICE: INTELLIGENCE SOURCES AND METHODS INVOLVED

PROJECT NUMBER: 8815	SESSION NUMBER: 1
DATE OF SESSION: 15 SEP 88	DATE OF REPORT: 30 SEP 88
START: 1042	END: 1218
METHODOLOGY: CRV	VIEWER IDENTIFIER: 003

1. (S/NF/SK) MISSION: Describe and identify the origin and mission of "Object B."
2. (S/NF/SK) VIEWER TASKING: Initially, coordinates only. Then cues to [origin of structure] and instructions to [track the persons connected with it].
3. (S/NF/SK) COMMENTS: Even though the monitor and viewer attended rigidly to CRV structure, it is this monitor's opinion that somehow we may have 'lost our bearing' somewhere during the session--the data just did not develop in a typical fashion.
4. (S/NF/SK) EVALUATION: [2] 1)

SG1J



~~SECRET~~/NOFORN - SKEET CHANNELS ONLY

CLASSIFIED BY: DIA-DT
DECLASSIFY : OADR

This document is made available through the declassification efforts
and research of John Greenewald, Jr., creator of:

The Black Vault



The Black Vault is the largest online Freedom of Information Act (FOIA)
document clearinghouse in the world. The research efforts here are
responsible for the declassification of hundreds of thousands of pages
released by the U.S. Government & Military.

Discover the Truth at: <http://www.theblackvault.com>

5
16 Sep 88
003

Site includes a complex/compound containing structure(s), and involving to some degree machinery/apparatus—though these devices are not central to the purpose, but merely adjuncts. People are here, both male and female, working together in an integrated, relaxed, vibrant sort of atmosphere. Doesn't seem to be Soviet (doesn't have a Soviet feel to it, nor does it seem authoritarian in any way), but is also not within US zone of influence. Political ambience seems non-aligned. [Operator note: impression present that mission here is not to explore something technical, but rather abstract in some sense. It is in a temperate location, a green area that is aesthetically pleasant, in a technically advanced culture (reminds me somewhat of Switzerland). Rolling hills, hazy, lush vegetation, rolling hills, clustered population—small towns, larger cities, "managed" landscape, a large-curving river with bridges: all relevant concepts to the overall geography with which the site is connected. There is also a murky, smokey city that is industrialized and polluting involving steel and factories, with a pall of smoke and fog hanging over, suggesting very strongly London. There is a structure that is residential, suburban, flat, rounded, white and green. An "aleinstehend" house—white with green edges, small front yard, steps, retaining wall in front; wrought iron, in a crowded small suburb on the edge of town. Trees. Some blocks distant from the house is a large, massive, rounded structure that is "like" gothic, with rounded, colored, sectional windows and other ornamentation, which reminds me of a church/cathedral. M

House has 2 levels up and a 1/2 basement, plus attic with dormers. The people present—one, sometimes two. Others often there, but not now, though maybe later. It's "like" they went to do something. The person(s) present have some expectation/excited anticipation as to what potentially might result. The person seems to be pleasant and likeable. I perceive no bad or negative intent here.

The half-basement is dim, dark, cluttered, involves storage, collection, preparation, tools, materials, parts, pieces, rubbish, plus "radio"/commo. Impression of a person sitting/listening. Alternately bored and mildly interested. Impression of person consulting a map. Now it's "like" it gets more crowded. People bump into each other a little more. They pack clothes, assemble, organize—going out to meet someone and do something. Like "finding out", collecting info. Almost "like" a business. Ongoing; one project to the next of similar purpose. Projects are conducted very similarly one after another. One thing that's round and about 8" to 12" long, metal, hollow thru middle (clinks when it bumps something hard). Fairly well made, "like" machined. Impression of a male in a dark turtleneck putting it in a small bag like a gym bag, along with other metallic objects "like" tools. One reminds me of a hand-drill. Impression they go out door with a goal of going somewhere. A car and driving is involved. Seems to be at most M

2-3 people. Sense they don't want a lot of attention--they prefer a certain amount of anonymity and limit time exposed to other people's observation as much as possible. The car goes down streets, cuts back, takes a complex route because no streets lead directly where they want to go. It goes "downtown" into more built-up, urban/industrial/Geschaefft areas. Stop and park near sidewalk next to a cyclone fence on right side of road, then walk down sidewalk. (A/S of waling up to a warehouse-like structure, meeting at door with someone and being ushered inside by a medium tall man with pinched cheeks who is nervous and uncomfortable having these people here.) Impression of exchanging/trading one thing for something else. Concept of several rounded, shiny objects packed in shredded paper. These people are only temporarily here. (Again, location is not US.) At some point, for some reason, money changes hands.

Activities seem to be in two different countries, widely separated. The people come to the second place to perform something that can't be done where they were. Personalities, and to a lesser degree, activity, reminds me of the Avengers on TV. Water and a boat seem connected. Image/impression of man getting onto a boat and waling thru a door into a cabin. The people don't maintain the same type of transport throughout their journey. Process goes to boat, then to land on a long, shiny, silver, metallic modern conveyance. Impression of passing through mountain area looking down into valleys and slopes with white-covered ground. For a while remain on ground, but then not on the ground anymore. The ground conveyance is intermediate, and not especially important. Then a possible aircraft is boarded--location where this occurs is bleak, barren, windswept--like heath or whatever--somewhat rocky; few tall trees; but conducive to aircraft ops. (AOLs of Teneriffe and Canary Islands). They proceed for a long, smooth, uniform, relaxing period of time. Low high-pitched hum (A/S of aircraft noises). Sense of flying east; other persons present who seem unconnected with the persons of interest. Sense of commercial flight. Sense of proceeding east/north of east. Relatively small aircraft. Area where it arrives is not green and damp like the location they originally came from. Sense of "deserty"--but not quite--environment. "Like" high desert, tundra, wide-open planes with profuse but low and hardy vegetation. People take a little "hop" to their final destination, with a sense of excitement/anticipation. People are looking forward to being where they're going. Sense of "peaceful" sort of meeting. Arrive at "area of operations". Sense of less developed area--perhaps 3rd world. People were to meet someone. Friendly greetings. Wind blowing down "like" helicopter wash. Sunny, bright, earth smells; food smells like bread and not-so-sweet pastry things. There is a structure that is offwhite, old, surrounded by an enclosure made of "like" masonry. Living and working areas share same general space. A pleasant exotic feeling, together with a western oriental ambience pervades the location. Most of the people are "shy"--i.e., quiet and reserved when strangers are around, especially foreigners--even a little nervous and apprehensive. Somewhat associated with this location

is a (A/S) huge rock formation reminding me of Ayers Rock in Australia.

Dimensions associated with object B are tall, tapered, spiring, high, vertical, solid, regular, sharp-edged sides, oblong. Other elements are both smooth and rough. AOL of Washington Monument and "Martian" monuments. People involved are "like" they are here at the behest of someone--a larger entity--organization/group/movement (A/S something "like" the Peace Corps. There seems still to be approximately 2 people--1 male, 1 female. They're friendly, enthusiastic and not performing a specific physical/hands-on action such as operating equipment or etc. More like teaching or exchanging ideas or philosophizing.

15 Paul
18 Sep 88
Ft. Meade, MD
Ed
1042

110698
259179 -  

A2 BK chills

110698
259179 -  - 

A. over
flat

B. low

A. and
up
now
solid

B. state

A. angle
was
solid / no

B. art

52
red
green
blue
green
black
white
smoke

had
wood
glossy
pungent odor
talking sound
long
thin
strip
width
tapered
rounded

A2 Bk
Main sampling about
this that seem fascinating
in some way

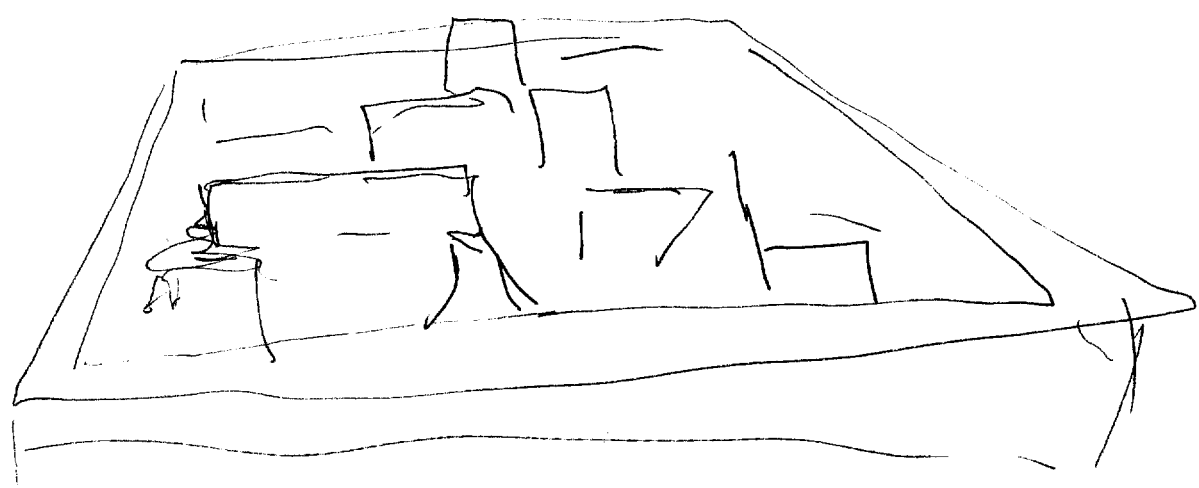

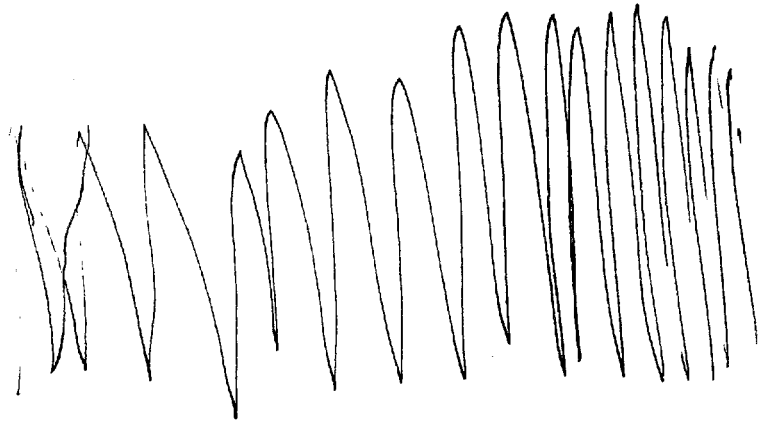
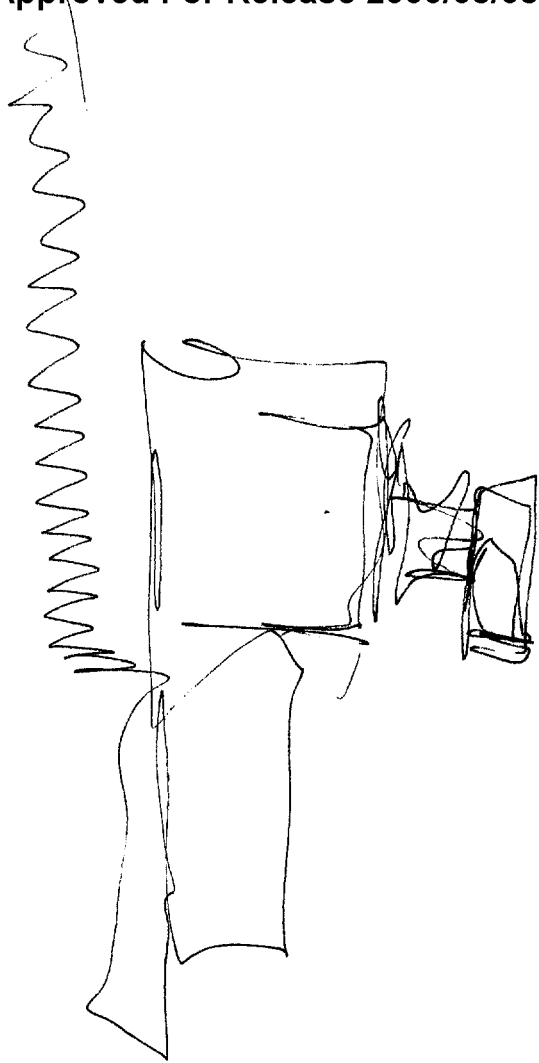

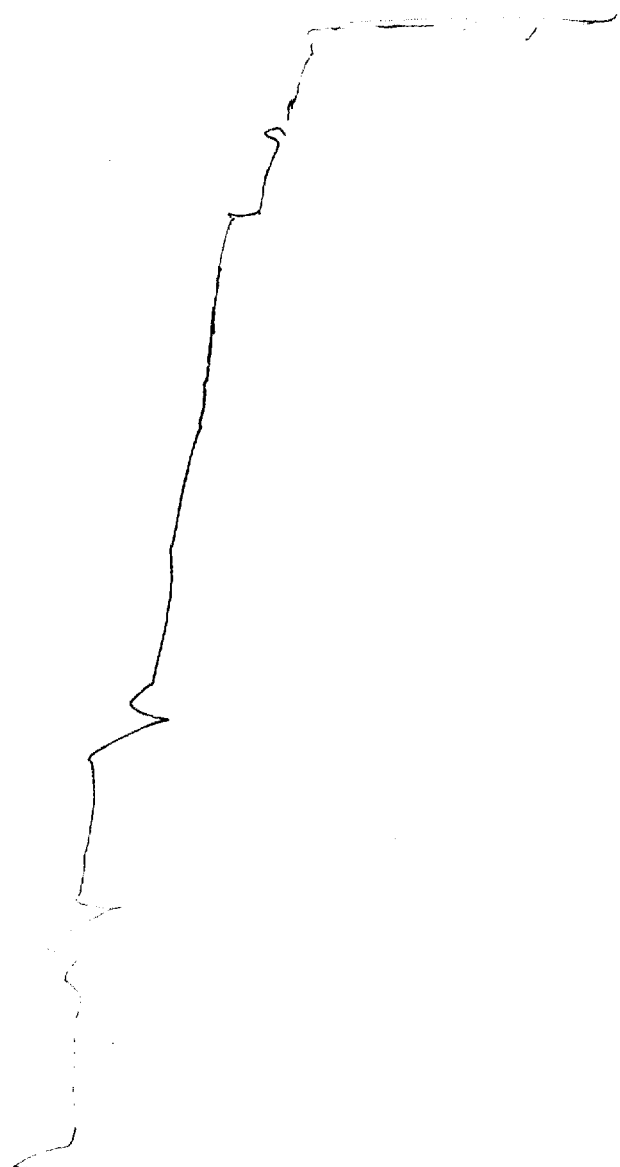

S2

D

AT

FI

T

I

HAL

ALS

Rhythmic

hard

adults,

fl.h
banded

High
ways

black

Complex

Complex
Compound

enclosed

containing

Structures
involving
apparatus
people

male &
female
integrator
work by agents

Am Bk
Oil
refinery

52
bel

ALS doesn't seem to be Soviet. Political atmosphere seems non-aligned. Impression that mission here is not to explore something technical but rather abstract in some sense.

location (c)

green
damp

temperat

A7 bk
pleasant

technically
advanced

remind
me of
Switzerland

humid
hazy
lush
vegetation

rolling
hills

Set's clustered population - small towns larger cities. "managed."

river

large
curving

52

mostly
sunny

city

industrial
polluting

steel
factories

days

Sun's

Part of smoke & fog hangs over

very much
like
London

Sprayer

flat
rounded
white
green

residential
suburb

Sub

house almost level - white, green edge; small front
yard - steps. Returns well. Wooded iron.

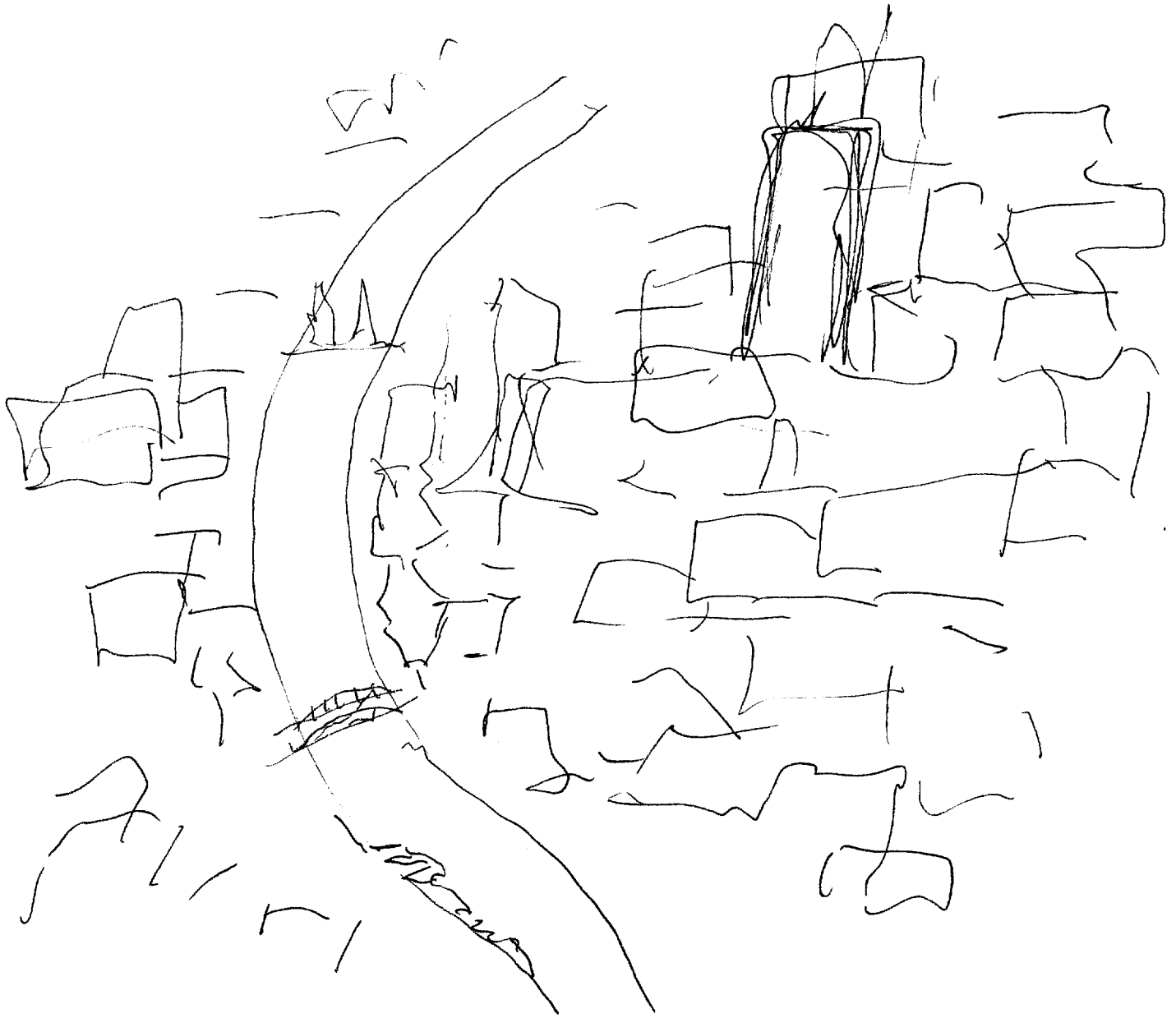

52

AZ E I I AZ

ALB

Structure

long
rounded
massive

gully

wider

round

colored

scattered

structures

As/side reminds me of a drandy/cathedral. Block,
distant from house.

AZ BIC
IRA
Terrorist
Team

89



SIV

9

S2

D

A2

FZ

T

I

ALL

AB

Stubs

only
2 level
up +
to basement
+
office w/dormers

people
present
one sometimes
two
Sitz
often even there
but not now
but may be later
want to do something
person(s) present
have some expectation/
excited anticipation as
to what potentially might
result. Person seems to
be pleasant + likeable.
Didn't perceive bad or negat. in
infant here.
half basement (c)

dinner
darker
(inferred)

Storage
Collection
preparation

tools

materials
parts
pieces
rubbish

radio
commo

5-12 person sitting / listening .. At least they know +
mildly interested.

map
person countries

people

5-12 "like" it gets more crowded. People bump into
each other a little more. Park clothes. Assemblies,
padding, organizing, going out to meet
someone & do something - like "filing out".
Collecting info. Almost "like" a business.
Ongoing; one project to one next of similar
purpose; projects are conducted very similarly
one after another. One thing that bond +
about 8"-12" long metal hollow tube wide. Clicks
when it bumps something hard. Fairly well-made

"like" included. Impression of noise in dark tower
putting in a small bag like a gym bag. Along

52

D

#2

#1

T

J

M

ALS

54 1/2 (cont) with other metallic object "like" tools.
One reminds me of a hand-drill.

Impression they go out door w/o goal of going somewhere. A ~~car~~ car. Drive. Yellow
Seems to be at most 2-3 people. Sense they don't want a lot of attention. They prefer a certain amount of anonymity + limit time exposed to other people's observations as much as possible.

Car Cross dan Streets cuts back takes complex route because we street lead directly where want to go. Cross "Downtown" into more built-up, urban/industrial / residential areas. Stop + park near sidewalk next to apartment fence. On right side of road walk down sidewalk.

ALS walk up to warehouse-like structure, meet at door + are ushered inside by a medium tall man w/ puffed cheeks who is nervous + uncomfortable having these people here.

for AG

Adm
trade
methods
for something
etc

for Bk
drugs
secrets

rounded →
hard
smooth

objects

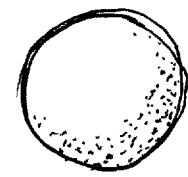

box

shiny

S+2 idea of several rounded shiny objects packed in
shredded paper.

S+2 people are only temporarily here.

location is not
US

42

D AI EI T I Adl Als

Adl/B
Attempt to
locate Attempt
to disrupt
Olympics.

Break

Resume

Selz At same point for same reason money
changes hands.

How they got from
where they were to
where they are (C)

Selz Seems to be in 2 different countries. then
people had to 2nd place to perform gymnastics that
can't be done where they were. Personalities + to been
degree activities remind of Averges on TV.

Selz water + a boat seen connected. Involvement of
man getting into boat + walking thru door into cabins.

13a

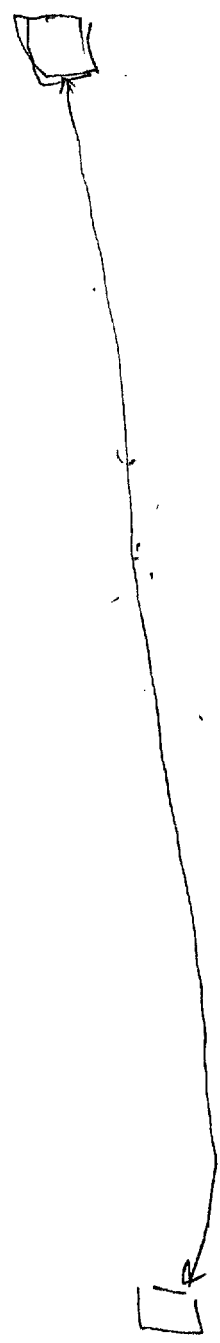

SVI

14

S2

A

AZ

EZ

T

I

AOL

AS

Sels boat to land to low slope silver metallic
modern ~~concrete~~ concrete, Impression of pattern then
mountain and looking down on mt. area. For
a while on ground, but then not on
ground anymore. Good concrete is intermediate
& not especially important.

aircraft

AOL BK
Covary
Islands

Sels location where POSS. aircraft is located
is relatively bleak, barren, windswept - like
Hawaii or whatever somewhat rocky; few tall
trees; but conducive to aircraft ops.

AOL BK
Teneriffe

Sels proved for low ~~swamp~~ uniform, cladding
series of trees. Low high-pitched beams

aircraft
w/3

series of flying east.

AZ BK
excitement
caused by
an airplane

S U T

D H T F E T I AUL ALB

94/2 Other people present who seem unconnected with the persons of interest. Sense of commercial flight.

proach E / norm of E. Relatively small acct.

Area where it arrives is not green & lush like location people originally started from.

Sense of "desert" - but not quite - environment.

N/A
Sub-sub
on form

Short little "hop" to final destination.

Sense of excitement/anticipation.

Subs people are looking forward to being where therapy going. Sense of "peaceful" sort of meeting. Arrive at "AO". Sense of less developed - perhaps 3rd world. People there to meet someone. Friendly greetings. Wind blowing down "like" helicopter wash.

Sunny, bright, early smells: food smells like bread + not-so-sweet pastry things

H2 Bc
waking up
hungry

SUI

S2

D

AJ

EI

T

I

hol Als

Structure (c)

offwhite

old

policed

"like
masonry"

Surrounds
enclose
embryonic

lily area
works
area

pleasant,
exotic
feeling

Suddy
fresh
mould
scent
feel

filigree

I skinned

people
dark complexts
shorter

5/16 most of the people are "shy" i.e. quiet + reticent

W... nervous + apprehensive.
Approved For Release 2000/08/08 : CIA-RDP96-00789R001800360001-3

SUI

17

52

AI

FE

I

I

AVL

A/S

big
fingible (c)

Als has rock formation "ilite" Ayus rock in Aust.
Object B (c)

1 tall
tapered
spiking
high
vertical
solid

smooth regular

oled 5/6

AVL BK
wash, mon.

Sharp-edged sides

rough

lites
burds
w/mortar
ends

AVL ~~Stk~~
Martian
monument
(moss)

17a



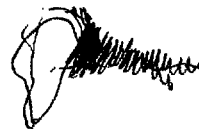
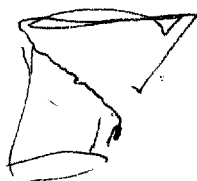

i



S U I

18

52

AL

F =

T

I

AK

ALS

Self people, wished me "like" thru at the behest of someone - a large entity - organization/group/movement,

Assumes they "like" the place cozse. Seem still to be 2 people - 1 male, 1 female - they're friendly, enthusiastic + not pertaining to specific physical/hands-on activities such as equip ops or etc. More like feeding or exchanging idea or philosophies.

1218