

SESSION INFORMATIONA. TARGET DATA:

Task/Target No. : 91-17-P-E Phase I  
Session No. : 1

B. PERSONNEL DATA:

Source No. : 018  
Monitor's No. : 370  
Beacon/Sender No. :

C. SESSION DATA:

Date Task Received : 16 OCT 91  
Session Date : 16 OCT 91  
Start Time : 1313  
Stop Time : 1408  
Method used : CRV  
Aids/Distractions (PIs) : None  
Pre-session hunches (AVs) : Mexico  
Date Summary Returned : 16 OCT 91

D. EVALUATION DATA:

Viewer's Estimate : Low  
Evaluator's Estimate :

E. SESSION SUMMARY:

Q: "Describe the vicinity/area of missing person."  
A: (SEE SKETCHS ATTACHED)

- 1) The area is an area of shifting sand dunes which have hard packed, flat ground between the dunes (see Fig. 1).
- 2) There is a range of mountains very far away (15-20 miles) to the south and extending northwestward (see Fig. 1).
- 3) Several miles to the northwest is an old tower of some sort (see Fig. 2).
- 4) Also to the northwest, but more westerly, is a large flat area where there are no dunes. This area is flat, hard-packed, very dry and has whitish-looking ground (see Fig. 2).
- 5) About 1/4 mile from the the missing person, to the southwest, is a parking area for tourists. The tourists are roaming around on the flat ground between the dunes in the area between the parking lot and the missing person (see Fig. 2).
- 6) Approximately 1/4 mile further to the southwest from the parking lot is a road/hwy which runs southeast-

This document is made available through the declassification efforts  
and research of John Greenewald, Jr., creator of:

# The Black Vault



The Black Vault is the largest online Freedom of Information Act (FOIA) document clearinghouse in the world. The research efforts here are responsible for the declassification of hundreds of thousands of pages released by the U.S. Government & Military.

**Discover the Truth** at: <http://www.theblackvault.com>

northwest (see Fig. 2). The entrance to the parking area from this road is a divided area with a large sign (see Fig. 3).

- 7) Approximately 1/4 mile down the highway to the southeast from this entrance is a larger sign with a rounded top.
- 8) This entire area is located east of Chihuahua, Mexico.

Q: "Is the target person alive or dead?"

A: The target person is dead. She is lying barely exposed under blowing sand.

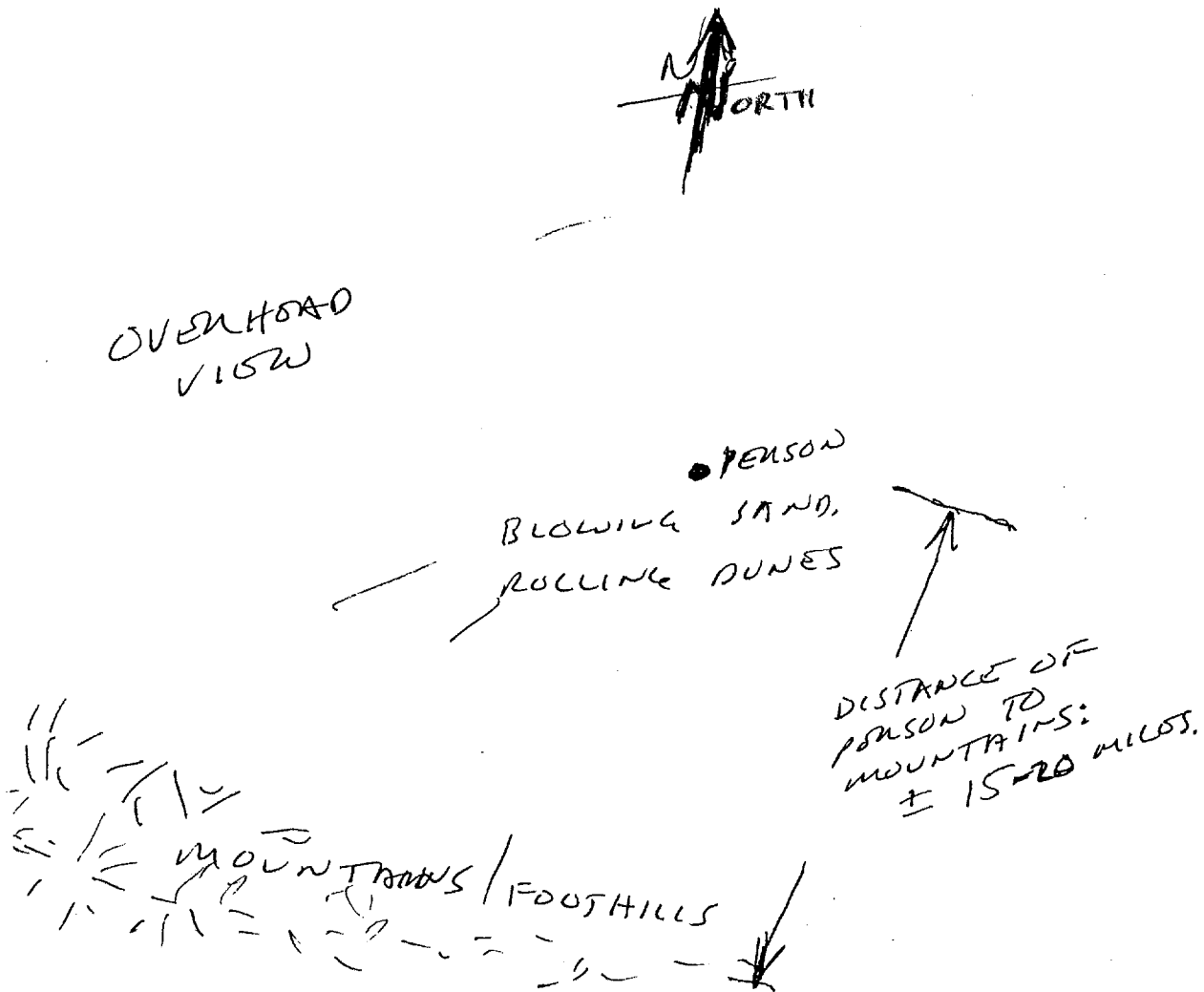

FIGURE 1: Overhead View of General Area

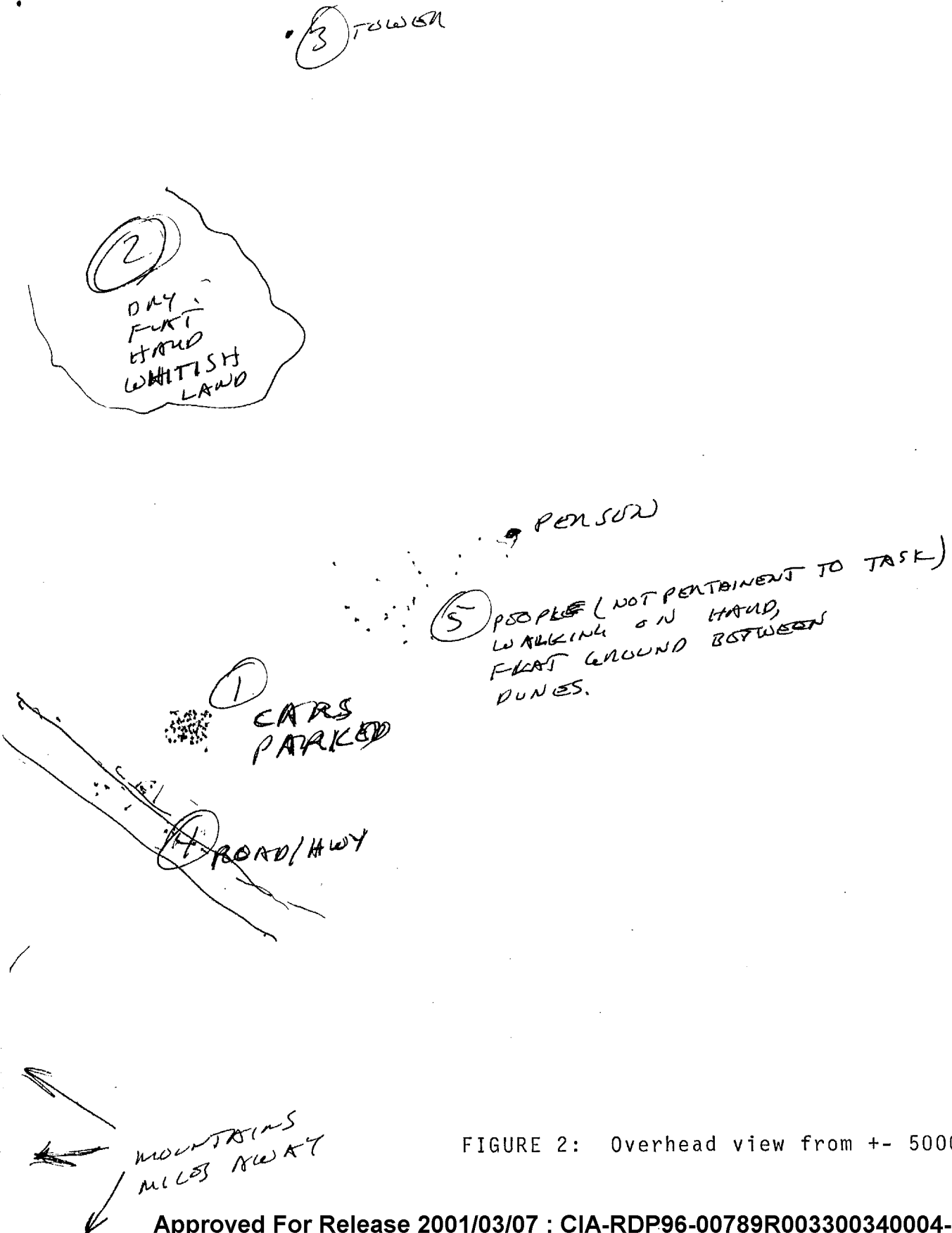

FIGURE 2: Overhead view from +/- 5000 Ft.

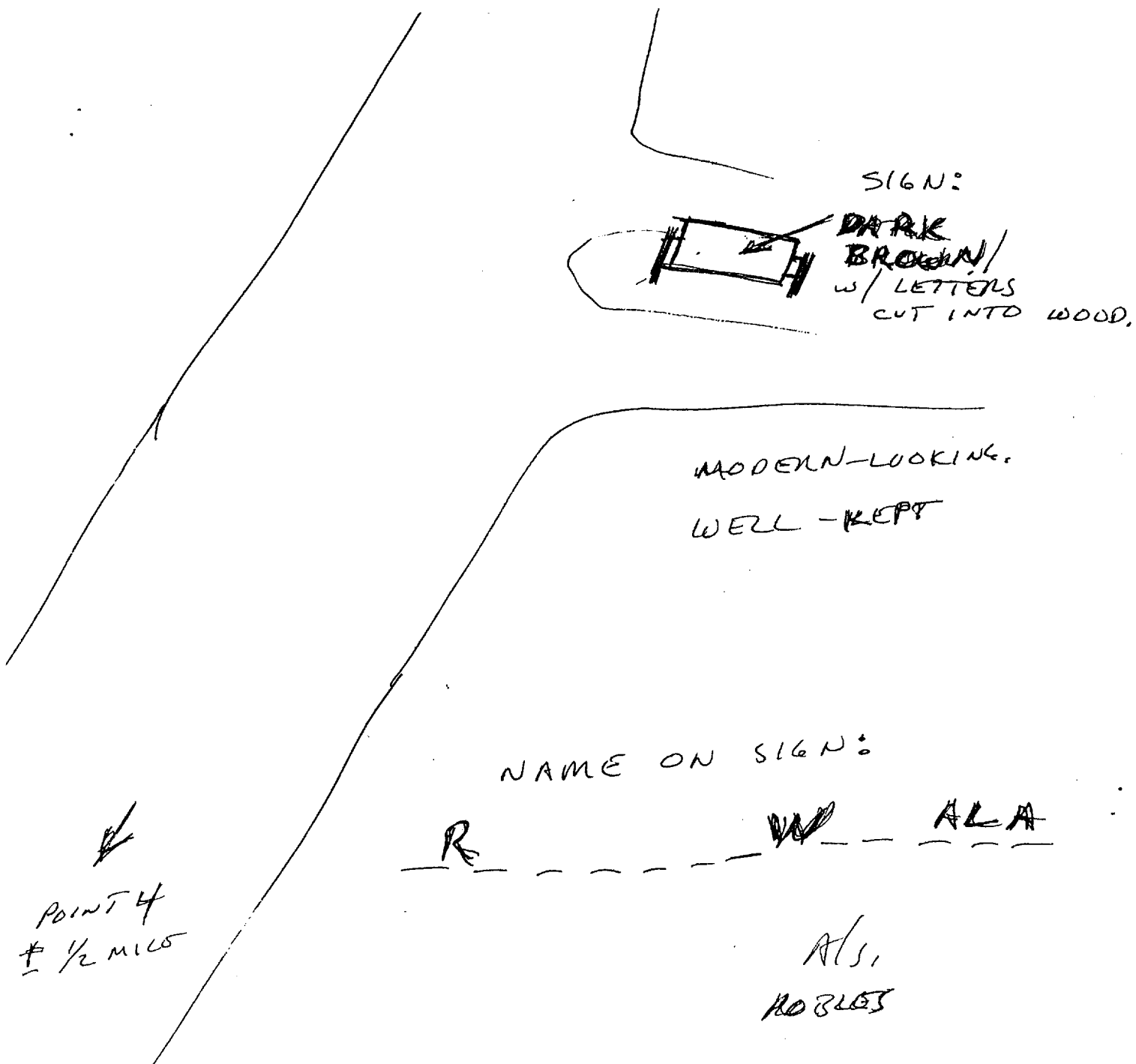

FIGURE 3: Entrance to Tourist Area

018

16 OCT 71  
1313 HAS  
F. M. S. A. D. S.  
320

P.I. DONS  
A.U. MEXICO

91-17-P-E

A: ACROSS  
S. M. S. T. H.  
UNITED  
B: LAND

S2: FINE  
QUALITY  
SOFT  
TAN  
YELLOW  
WIDE

91-17-P-E

A: ACROSS  
S. M. S. T. H.  
B: WATON

CONF. BAK.  
FOODS POWDER

ACZ P. M. L. C. -  
CONF. BAK. POWDER

(2)

91-17-P-E

A: ACROSS  
HARD  
SMOOTH

B: \_\_\_\_\_

SZ: SMOOTH  
FIRM

AOR BAK  
WATER

91-17-P-E

A: ACROSS  
SMOOTH  
HARD

B: \_\_\_\_\_

SZ: FLAT  
ROUNDED  
CURVING  
SOFT  
SPONGY  
GIVING  
POWDERY

AOR BAK: CLEARLY  
~~NO CLEAR CUT~~



3

ACR MK.  
LIKE A SAND-STEAK  
ON THE DESERT.

91-17-P-E

A: ACROSS  
TERRA  
B: LAND

S2: FLAT  
HARD  
BROWN  
TAN  
FLAT.

ACR MK.  
"PACKAGE" OF POROSITIES:  
POROSITY LYING UNDERNEATH  
SURFACE.

ACR MK.  
POROSITY BUNIST/DEAD

4

S2: GENTLY  
FINE  
SOFT  
POWDERY  
PILSD

\*

ACR AKA  
VISUAL:  
SAND DRIFTS  
W/ DARK (SMTE) EXPOSED.

S2: FLAT  
HORIZONTAL  
WINDY FEEL  
DUSTY SMELL  
WIND SOUNDS  
QUIET  
WIDE  
OPEN  
FLAT

AC AKA

DRIFTS / AKA

5

SZ O A I O T I per r/s.  
(PERSON)

DRUG

PLUMP

INERT

S4 1/2 DEFINITE FEELING OF DEATH.

(my) ~~MEMORY~~ <sup>A/S.</sup> OF DRUG AGENT KILLED IN MEXICO SOME YEARS AGO.

SS!

(6)

DRUG ACCOUNT

~~SECRET~~

PRISON SCHEDULES?

LYING DOWN  
UNDER GROUND

FOUL PLAY

MEXICO

MURDER

MALICIOUS FEMALE INVOLVED

VICTIM

DARK SKIN

INTONUM SUMMARIES:

PERSON IS DEAD, LYING PARTIALLY

~~UNDER~~ COVERED BY LOOSE, BLOWING SAND.

DESCRIBES THE AREA.

(2)

S2 D M ST T | AIR W/S.  
(AREA)

LENS

COOL

WINDY

"POPPERY" FEELING ON SKIN

W/S.  
LIKE BLOWING SAND.

AOR BAK.  
WHITE SANDS, N.M.

S2 D M ST T | AIR W/S.  
(AREA)

TAN

LOOSE

POWDERY

WIDE

ROLLING

8

S2 D H C E T 1 NW als.

S4 1/2 NOTABLE ABSENCE OF VEGETATION.

DUNES

VISUAL:

VERY DISTANT HILLS

ORANGE COLOR.

PARIS.

10

(9)



GROUND LEVEL VIEW  
AS SEEN, LOOKING TOWARD  
SUN, FROM PERSON'S POSITION

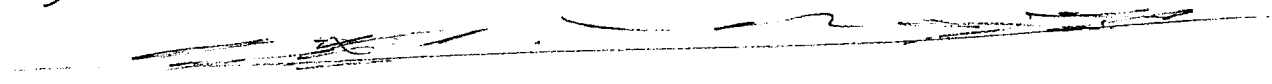

OVERHEAD  
VIEW

• PERSON

BLOWING SAND,  
ROLLING DUNES

DISTANCE OF  
PERSON TO  
MOUNTAINS:  
± 15-20 MILES.

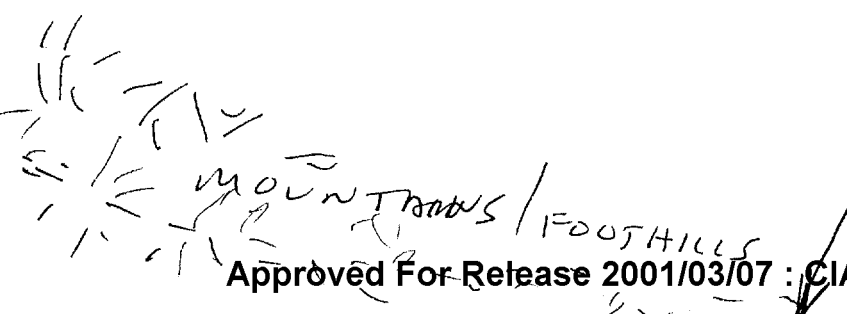

10

S4 1/2 BOTTOM OF ROLLING DUNES IS  
HARD, FLAT GROUND



MOVE TO 5000 FT. ABOVE POUNSON'S  
LOCATION + DESCRIBE SPECIFIC  
IDENTIFIERS.

S2 0 100 500 1000 1500 2000

(SEE MAP, P. 10A)

CARS PARKED

①

AOL

WHITE SANDS N.M.



10A

(SEE XCPT, P. 10)

• ③ TOWER



• PERSON

⑤ PEOPLE (NOT PERTINENT TO TASK)  
WALKING ON FLAT,  
FLAT GROUND BETWEEN  
DUNES.

① CARS  
PARKED

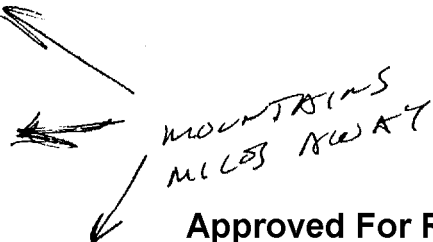
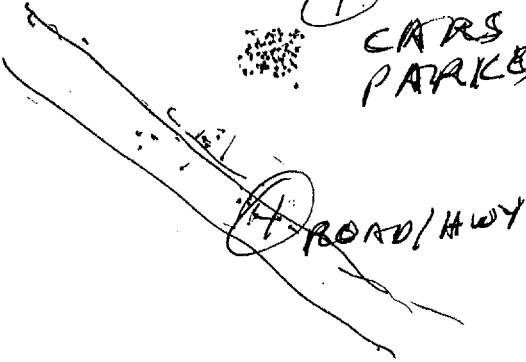

(585 MAY, P. 10A)

(14)

S2 0 M 5 T 1 AM 1/5

(2) FURT

HAND

PACKED

WHITISH COLOR

LOW-MEDIUM ELEVATION.

(1)

BLUE

LT. BLUE

BLUE TRIM

SIGHT-SEEING FEEL

TOURIST FEEL

STRUCTURE

STORE

LARGE WINDOWS

12

S2 @ m of T, 1982 m/s,

3

SMALL  
VERTICAL  
DARK COLOR  
UNOY

TOWN

OLD  
UNOY.

4

SAME  
FLAT  
LONG

ROAD  
HIGHWAY

CLOSE TO PARKED CARS

5

5 1/2 IMPRESSION OF PEOPLE WALKING  
ON FLAT, HARD GROUND BETWEEN  
TWO DUNES. — PEOPLE NOT RELATED/  
CONNECTED TO PERSON.

13

(SEE MAP, P. 8A)

S2 D A1 D T 1 BEN SLS,

4 DARK

PROUMENT

S4 1/2: LITTLE TRAFFIC = TRAFFIC CAN  
BE SEEN OFF IN FAR DISTANCE.

STRUCTURE

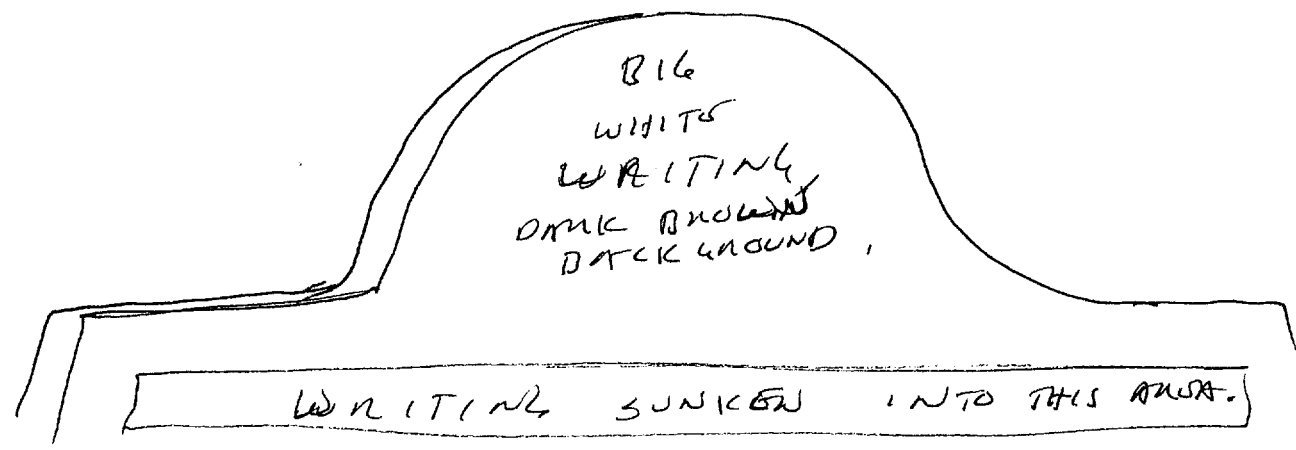

S4 1/2 CANNOT SEE POINT #1 FROM POINT #4,  
BECAUSE OF UNUSUAL GROUND. DISTANCE,  
IS LESS THAN 10 MILES.

17

SZ O M O T 1 NOC ALI,

TRAVEL UP ROAD - LOOK FOR SIGNS

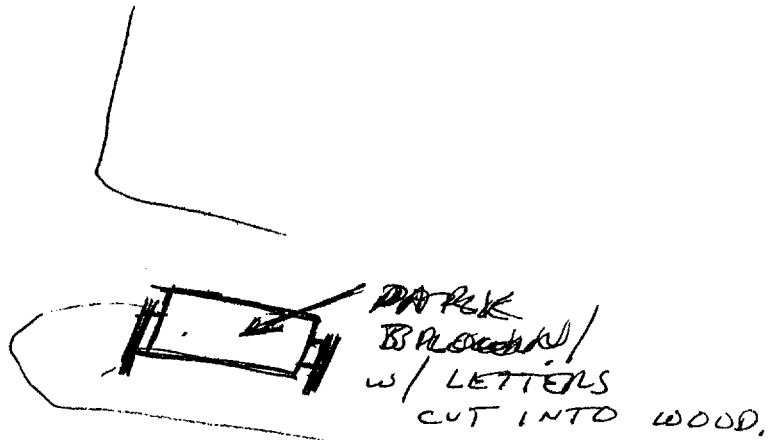
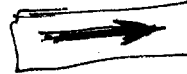

MODERN-LOOKING.  
WELL-KEPT

R W ALA

POINT 4  
± 1/2 MILES

ALSI  
ROBLES

SESSION TASKING SHEET

Source No. \_\_\_\_\_

Date Task Initiated 16 Oct 91

Suspense Date { 17 Oct 91 - PHASE I

Task/Targeting No.: 91-17-P-E } 18 Oct 91 - PHASE II

Project Type: SEARCH (PROFICIENCY / ops).

Targeting Method/Technique: \_\_\_\_\_

Target Data Desired:

1. DESCRIBE KEY TARGET FEATURES (include forms, shapes, spatial aspects, color, motion/dynamics):

- Emphasize the following: \_\_\_\_\_
- Do the following perspectives:
  - Ground-level
  - Overview
  - Other: \_\_\_\_\_

2. IDENTIFY KEY TARGET CONTENT (include meaning, purpose, function, nature of activity, type/nature of people, if present):

- Emphasize the following: \_\_\_\_\_

3. IF PERSONALITY, DESCRIBE: \_\_\_\_\_

4. OTHER: (or see attached) LOCATE MISSING PERSON

5. ADDITIONAL GUIDANCE: (see attached)

TWO PHASES ; SEE ATTACHED.

16 OCT 91

91-17-P-E

PHASE I:

TASK: LOCATE MISSING PERSON

GIVEN: (1) PERSONS NAME: ROSA GONZALES

(2) LAST SEEN: 4 OCT 91

REQUIRED: (1) PROVIDE DESCRIPTION OF VICINITY / AREA OF MISSING PERSON, TO INCLUDE:

- OVERVIEW OF AREA
- SPECIFIC LAND MARKS.

(2.) IS PERSON ALIVE OR DEAD?